

Photoelectric Sensor
BOS 20K-ZU-1FR-S75-C
Sn=mm
Basic Unit for Fibre optic

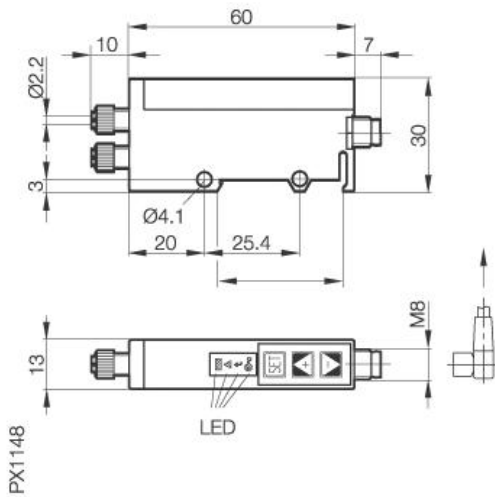

Common Data

Series	20K
Sensortype	Basic Unit for Fibre optic
Switching frequency	1000 Hz
asured operating distance Sa	belonging to Fibre optic
Indication	yes, green LED
Switching element on	red LED Function-/Errorindication
Indication Special funktion	0...+60°C
Ambient temperature	<500 µs
On-delay	<500 µs
Off-delay	Red light
Light	Teach in
Sensitivity Adjustment	belonging to Fibre optic
Blind zone / min Reflector distance	Stabilization indicator/Time
Special funktion	
function	
Permissable ambient light	10000 Lux
Output funktion	light-on or dark-on

Mechanical Data

Measurements	60x30x13
Shock	Halfsinus, 30gn, 11ms
Vibration	10...55Hz, 1,5mm Amplitude 3x2h
Housing material	PMMA
Degree of protection	IP65
Connection	Connector S75 (M8,4-pin)
Weighth	50g

Electrical Data

Current	DC
Switching funktion	NO/NC
Output	PNP/NPN
Rated operational voltage Ue	24V DC
Rated operational current Ie	100mA
Supply Voltage	10...30V DC
Ripple	< 10% from UB
Frequency of Supply Voltage	DC
Voltage drop	<2V
Short protection	yes
Rated insulation voltage	75VDC
max. Load capacity	0,05µF

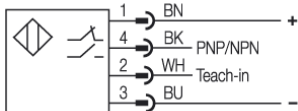

Utilization categories
 Insulation class

Datasheet number:

Definitions see general catalog.
 If not otherwise noted, ratings according to
 IEC 60947-5-2 (DIN EN60947-5-2)

Balluff GmbH
 Schurwaldstrasse 9
 73765 Neuhausen a.d.F.
 Phone (07158) 173-0 Fax (07158) 5010

Datenblatt by CD-ROM - 04/2007

BALLUFF
 sensors worldwide